

In the event of an alarm sounding ensure everyone leaves the building as soon as possible.

Do not silence a fire alarm until you know the cause of the alarm and when all occupants are safely outside the building. The light on the alarm will be flashing Red once every second.

- Do not run.
- Do not stop to collect belongs.
- If it is safe to do so, close all windows and doors as you escape to prevent the spread of fire.
- Smoke is the main cause of death from fire. If trapped inside the building, cover your mouth, conserve breath and crawl to safety.

6. ALARM MAINTENANCE

A regular program of fire alarm maintenance will help to keep your alarm in good working order.

- Test the alarms weekly
- Vacuum the alarms every six months and wipe them with a damp cloth.
- Do not paint the alarm.

A smoke alarm is a sensitive life-saving device. The life of this alarm can be significantly reduced by adverse environments, incorrect location and a failure to regularly clean and maintain it according to the instructions. Incorrect location and a lack of reasonable care may also cause it to malfunction and will invalidate the warranty.

7. BATTERY REPLACEMENT

Replace with any Duracell LR03 Alkaline AAA.

The life of the batteries can be significantly shortened by periods of storage or use in temperatures below 5 degrees or above 30 degrees C. They will also be shortened by frequent or extended periods in full alarm often caused by conditions such as cigarette smoke, steam, aerosol spray and condensation. In these circumstances the warranty will be void. If this happens at night you can press the test button to silence the battery warning for 10 hours. Replace the alarm as soon as possible.

8. TROUBLE SHOOTING

Problems are indicated in five ways:

1. The alarm beeps twice every minute indicating a malfunction.
2. The alarm beeps once every minute indicating a low battery.
3. The full alarm sounds for no reason. (A repeating series of three beeps with flashing light)
4. The alarm does not sound when pressing the test button.
5. The red light remains steadily on or off. (i.e. does not flash approximately once every minute, when the unit is not in alarm).

Inspect for obvious damage. Check that the alarm has been installed in accordance with the instructions. In the case of repeated nuisance alarms, check that it is free from dust, cobwebs and external contamination from such things as cigarette smoke, drying paint, spray from household aerosols and steam that will ultimately shorten the life of the alarm and invalidate the warranty. If this does not correct the problem, do NOT attempt to repair. There are no user serviceable parts inside. If the smoke alarm is within the warranty period and terms, indicate the nature of the problem and return the unit with proof of purchase to the address at the end of this manual. Units beyond warranty cannot be economically repaired.

9. PRODUCT WARRANTY

Fireblitz guarantees to you, as a purchaser, that the enclosed fire alarm will be free from defects in material, workmanship or design under normal use and service for a period of 5 years. This Guarantee is not assignable. Our liability to you, under this guarantee is limited to repairing or replacing any part which we find to be defective in material, workmanship or design, free of charge to the customer, upon sending the alarm with proof of date of purchase, postage paid to Fireblitz Extinguisher Ltd, Units 15/17 Manford Industrial Estate, Manor Road, Erith, Kent DA8 2AJ The terms of this guarantee will not apply in the following circumstances: If the alarm has been modified, dismantled, contaminated, damaged, neglected or otherwise abused or altered following the date of purchase, or if it fails to operate due to incorrect siting, installation, maintenance or inadequate or over voltage AC electrical power, or damage caused by failure to abide by the instructions supplied. It is specifically drawn to the users attention that substantial periods in alarm will shorten alarm life, during which time the fire alarm will have provided

valuable protection; no Claim under the guarantee will be entertained. The liability of Fireblitz Ltd, arising from the sale of this alarm or under the terms of this guarantee shall not in any case exceed the cost of replacement of the alarm. In no case, shall Fireblitz Ltd be liable for consequential loss or damage resulting from the failure of the alarm or the breach of this or any other guarantee, express or implied or for damage caused by failure to abide by the instructions supplied. This guarantee does not affect your statutory rights.

Fireblitz Extinguisher Ltd.

Units 15-17 Manford Industrial Estate, Manor Road, Erith, Kent DA8 2AJ

Telephone: 01322 342238

TECHNICAL HELPLINE 0800 008 6568

or Text on 07885 831239

Email: customerservices@fireblitz.co.uk



1438-CPR-0470 17

Models FHB-150 and FHB-155

(Smoke Alarm for Household or similar residential applications)

DOP Ref. FHB-150/155

Manufacturer: SUZHOU PRIMETECH ELECTRONICS CO.,LTD.

16 Chunqiu Rd, Panyang Industrial park, Suzhou City, China.

EN 14604: 2005+AC:2008

Notified Body: 1438 (CNBOP)

Firehawk
SAFETY PRODUCTS

Compact Design
with
TSE-Technology

BATTERY OPERATED
Midi Smoke Alarm

MANUAL



FHB150/FHB155

READ AND RETAIN THIS USER MANUAL

1. PRODUCT OVERVIEW

The Midi RF photoelectric type smoke alarm is approved to EN14604-2005, the most recent and rigorous European Smoke Alarm Standard. The unique Photoelectric sensing chamber is particularly sensitive to slow smouldering fires typically originating in living rooms, bedrooms and hallways whilst being highly resistant to nuisance alarms.

The MidiRF comes with 2 AAA batteries. The expected live of the battery can be significantly reduced by adverse environments, incorrect location and a failure to regularly clean and maintain them according to the following instructions. Incorrect location and a lack of reasonable care may also cause them to malfunction and will invalidate the warranty.

2. PRODUCT FEATURES

- Approved to EN14604:2005, Smoke alarm devices.
- Unique detection chamber.
- Bespoke software maximizes detection ability and false alarm rejection.
- Red light flashes approximately every minute confirming unit is receiving power and ready to detect fire conditions. (Quiescent Mode)
- Low Battery Warning - alarm gives one beep every minute with three flashes of the red light every eight seconds
- Low Battery Warning Silence - Low battery warnings often start at night. Silence the audible warning for ten hours by pressing the test button, thus avoiding removing the alarm from its mounting plate. (The red light will flash three times every eight seconds during this period). The batteries can then be replaced when convenient the following day.
- Test Button tests sensitivity, circuitry, battery and alarm sounder.
- Loud 85 Decibel Piezo Electric Alarm – Automatically resets when hazardous condition has passed and chamber is clear.
- Alarm Silence - Silence your smoke alarm by momentarily pressing the test button. Ideal in nonemergency situations where nuisance alarms may have been created, for example, by steam. The red light flashes every 8 seconds to remind you that the smoke alarm has been silenced and will automatically reset to quiescent mode in 10 minutes.

3. CHOICE AND LOCATION OF ALARMS

Optical Smoke Alarms are best for sensing smouldering fires and are therefore best suited for rooms containing furniture, bedding and clothes such as escape routes, lounges, bedrooms and other living rooms.

Heat alarms are most suitable for kitchens, boiler rooms, workshops and garages where dust, dirt and moisture would contribute to nuisance alarms. NOTE - Heat alarms should not be used in escape routes and should always be interlinked to smoke alarms.

For minimum protection, install at least one smoke alarm on each level of your home. They should be installed in hallways, corridors and all escape routes from the building and within 3 meters of all bedroom doors. All alarms should be interconnected.

Recommended siting of smoke and heat alarms in:

SINGLE STOREY HOME WITH ONE SLEEPING AREA



SINGLE STOREY HOME WITH TWO SLEEPING AREAS

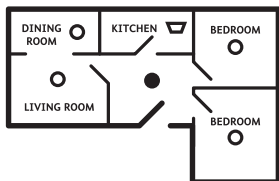

MULTIPLE STOREY HOME WITH MULTIPLE SLEEPING AREAS

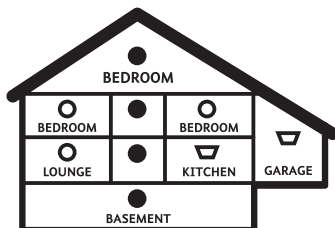

- SMOKE ALARMS FOR MINIMUM PROTECTION
- SMOKE ALARMS FOR INCREASED PROTECTION
- ▽ HEAT ALARMS

Recommended position of alarms in a room, corridor or escape route:

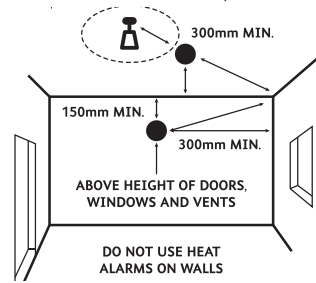

Recommended position of alarms on apex ceilings:

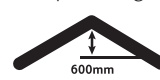

The life of this alarm can be significantly reduced by adverse environments, incorrect location and a failure to regularly clean and maintain it according to the following instructions. Incorrect location and a lack of reasonable care may also cause it to malfunction and will invalidate the warranty.

- Do not locate near fans or extractors. These can pull smoke and heat away from the alarms.
- Do not install in or near high humidity areas such as showers, bathrooms or kitchens where humidity levels exceed 85% or the room temperature exceeds 40°C or falls below 0°C. These may cause nuisance alarms and damage the detector.
- Do not install in the peak of an "A" frame or sloping ceiling. This may delay smoke and heat reaching them due to the presence of dead air.
- Do not install less than 300mm from walls and light fittings when mounted on the ceiling where heat and dead air may prevent smoke reaching the alarm.
- Do not install in insect infested areas.
- Do not install in areas subjected to heavy concentrations of cigarette smoke that will cause nuisance alarms and the alarm to become contaminated.
- Do not install smoke alarms in kitchens, boiler rooms and garages where fumes and dust may cause nuisance alarms.
- Do not install heat alarms in sleeping areas; for example, bedrooms, nurseries, playrooms or areas where the elderly and disabled may spend long periods of time.
- Do not install on poorly insulated walls and ceilings where cold air boundary layers could prevent smoke reaching the alarm.
- Do not install near objects that could prevent smoke and heat reaching the alarm.
- Do not install within 1500mm of fluorescent light fitting that could trigger nuisance alarms.
- Do not paint the alarm. The location of the alarms must be in accordance with applicable building regulations, in particular Part B. Further help and guidance can also be found in BS5839 part 6.

Further Information on Alarm Location

- At least one smoke alarm should be installed in the escape route on all floors of the building.
- The detection element of smoke alarms should be between 25mm and 600mm below the ceiling, or in the case of heat alarms between 25mm and 150mm
- Smoke and heat alarms should be at least 300mm from any wall or light fitting.
- If ceiling mounting is impractical smoke alarms may be installed on walls provided that the area is no longer or wider than 10 metres and the total area does not exceed 50m² and that:-
 - The detection element is between 150mm and 300mm below the ceiling.
 - The bottom of the detection element is above openings such as vents, doors and opening windows
 - They are not mounted close to or above heaters or air-conditioning vents.
 - Where smoke alarms are located in a hallway, corridor or landing, the alarm should be no further than three metres from any bedroom door to assist audibility behind closed doors.
- 6. No point on the ceiling in any room, hallway or corridor should be further than 7.5 metres from any smoke alarm.
- 7. Heat alarms should not be used in escape routes from the building. Where

used in other areas, heat alarms should be no more than 5.3 metres from other heat or smoke alarms.

- Do not install heat alarms in sleeping areas; for example, bedrooms, nurseries, playrooms or areas where the elderly and disabled may spend long periods of time.
- Do not install heat alarms on walls.
- To give the earliest warning of a developing fire, smoke alarms should be installed in all the rooms of your home and interlinked. (other than those in point 2 of Choice and Location of Alarms above).

4. INSTALLATION PROCEDURE

The alarm is supplied with two high capacity AAA batteries. Always used high quality alkaline replacements.



- Remove the alarm from its mounting plate by twisting it anti-clockwise and fit the two batteries supplied in the correct orientation by referring to the picture in the battery bay.
- Refit the cover.

Fixing the alarm to the mounting surface

Using the screws and wall plugs supplied, attach the baseplate to the ceiling, offer up the alarm and twist it clockwise to lock it to the ceiling.

Pairing the alarm to others

The Mid RF can be paired to up to 15 other Midi RF's so that when one alarms they all sound.

1. Insert the batteries into all alarms you wish to pair.
2. Press and hold the test button on all alarms in turn until the alarms beeps and the green light behind the grille under the test button flashes every second.
3. Make sure the green light on all alarms is flashing every second and wait 4 to 5 minutes until each alarm beeps twice and the green light stops flashing.

Testing the alarm

Press and release the test button and then again after approximately 4 seconds, to test the alarm. The alarm should sound three times with a flashing red light then stop. All other paired alarms should beep three times and then sound the full alarm. The connected alarms will continue to sound for up to 30 seconds.



After testing, check that the red light flashes approximately every minute. The green light should flash once every 5 minutes to confirm it is paired to other alarms. Test the alarm once a week to ensure correct operation.

WARNING: The electronic test button provides a full test of the alarms functionality. Do not try to test the alarm using heat, smoke or naked flame as damage will occur.

5. USER INFORMATION

Protect your Home Against Fire

Contact your local Fire Brigade for a home safety check, this information is free and will identify potential fire hazards in and around your home.

Make sure all occupants of the home know what a fire alarm sounds like. Prove and practise a fire escape plan and arrange a suitable and safe assembly point.

What to Do if the Alarms Sound

Alarms sounds are as follows:

Full alarm indicating smoke and fire	Repeating series of 3 beeps every 4 seconds with flashing light	••• ••• ••• •••
Low Battery	Single beep every minute	• • • •
Fault	Double beep every minute	•• •• •• ••

WARNING: Do not store alarms in temperatures below 5 degrees and above 30 degrees, and in low humidity; this may cause beeping and nuisance alarms when first installed. These will clear after a short time when the alarm has become acclimatised. Extended periods under these conditions will reduce the life of the alarms and invalidate the warranty.